

EL174

High Intensity Line Light



- Aii** Designed for Large Area or Line Scan applications
- Aii** Available in 152mm (6") increments up to 2134mm (84")
- Aii** Washdown Version Available in 152mm (6") increments up to 1220mm (48")

Ordering Information

Standard Product Variation:
Shipped Within Three Weeks

EL174	Lighted Length (# of LEDs)	-	Spectral wavelength	Optional power compatibility		Alternative Connector
	XXX		XXX	Heat Sink Option	Wash Down Option	XXX
	6 LEDs = 152.4 mm (6")		(blue) 470 (green) 530 (amber) 590 (red) 625 (white) WHI (infrared) 850	H <small>(See spec below)</small>	IC C2 C3 C5 24	W M12*

Optimal working distance:

304.8mm (12")

IC = ICS (requires 24v power supply)

C2 = Ai Connector

C3 = Pulsar 710 Connector

C5 = Pulsar 320 Connector

* Available with IC, IS, and 24v options only

Built-to-order lights are non-returnable.

Dimensional Information

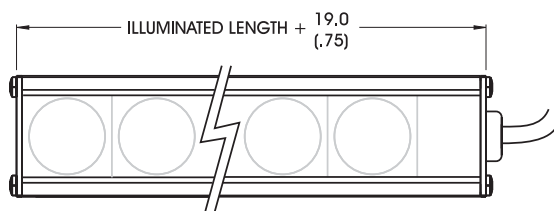

Cable Length: 1.5 Meter (59")

[Click for Installation Models & Drawings](#)

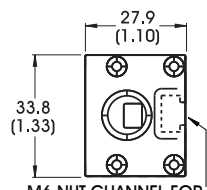

M6 NUT CHANNEL FOR MOUNTING (HARDWARE INCLUDED)

DIMENSIONS ARE IN MILLIMETERS (INCHES)

Optional Heat Sink

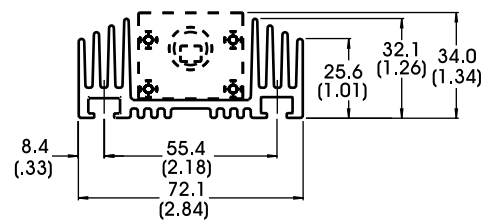

DIMENSIONS ARE IN MILLIMETERS (INCHES)

Current Specifications

Maximum draw per 152mm (6") length

	uv	blue	green	amber	red	infra-red	white	
@24	350	350	350	350	350	350	350	mA

Product Information

Product Lifetime: 50,000 hours

Operating Temperature: 0-60° C